



Decentralized ventilation unit, with heat recovery, for single rooms in domestic or commercial applications. Elegant design that allows its adaptation to any environment. Brushless motor with low consumption electronic control. Ventilation system through an reversing motor and a heat exchanger with a performance up to 93%. Designed for a continuous operation, the unit adjusts the airflow proportionally to the humidity level (model RD), ensuring excellent indoor air quality.

Characteristics

- Ceramic heat exchanger.
 - Alternative ventilation system.
70 second cycles in supply and extraction.
 - Filter at both ends of the exchanger.
 - Defrost control not required.
 - Flow up to 30 m³/h model 100.
 - Flow up to 60 m³/h model 150.
 - Supply voltage 220-240V.
- MODEL 150 / 100
- 2 speeds per manual control.
- MODEL 150 RD / 100 RD
- 3 speeds.
 - Remote control.
 - Possibility of synchronizing different equipment (up to 16).
 - Proportional flow according to hygrostat.



Remote control of model RESPIRO RD

- 3 speeds
Humidity control
Modes:
- Only extraction
 - Only supply
 - Reversing impulsion and extraction.
 - Security is only activated if humidity exceeds the limit.



Ceramic heat exchanger
with performance up to 93%, protected with a G3 filter at both ends



Internal front cover
of elegant design, which allows adaptation to any environment.

Specific applications



VMC
Single
Dwellings



VMC
Multi dwelling
blocks



Heat recovery
units

TECHNICAL CHARACTERISTICS

It is essential to check that the electrical characteristics (voltage, current, frequency, etc.) of the motor which appear on the motor plaque are compatible with those of the installation.

Model	Speed	Voltage 50 Hz (V)	Absorbed power (W)	Maximum airflow (m ³ /h)	Sound pressure level (dBA) at 3 m	Maximum performance	Medium performance
RESPIRO 100	1	220-240 VAC	3,9	15	19	93%	70%
	2	220-240 VAC	7,9	30	29	93%	78%
RESPIRO 100 RD	1	220-240 VAC	3,9	15	19	93%	70%
	2	220-240 VAC	5,9	22,5	24	93%	74%
	3	220-240 VAC	7,9	30	29	93%	78%
RESPIRO 150	1	220-240 VAC	4,9	30	13	93%	70%
	2	220-240 VAC	8,9	60	23	93%	78%
RESPIRO 150 RD	1	220-240 VAC	4,9	30	13	93%	70%
	2	220-240 VAC	6,9	45	20	93%	74%
	3	220-240 VAC	8,9	60	23	93%	78%

OPERATING PRINCIPLE

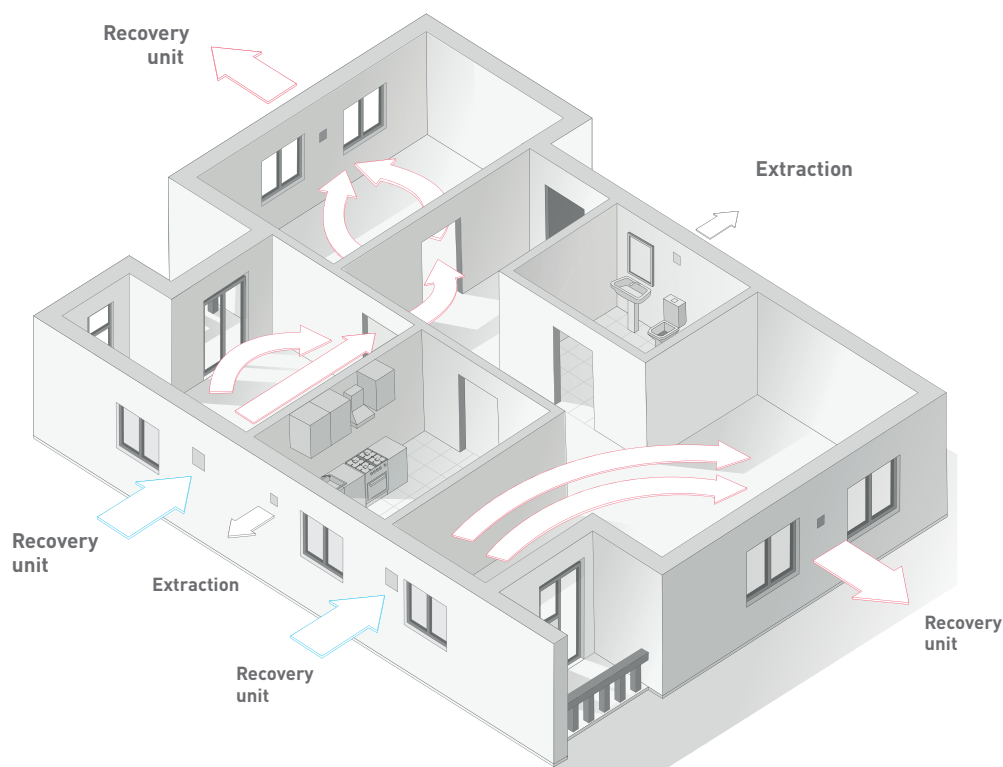

WINTER ENERGY RECOVERY

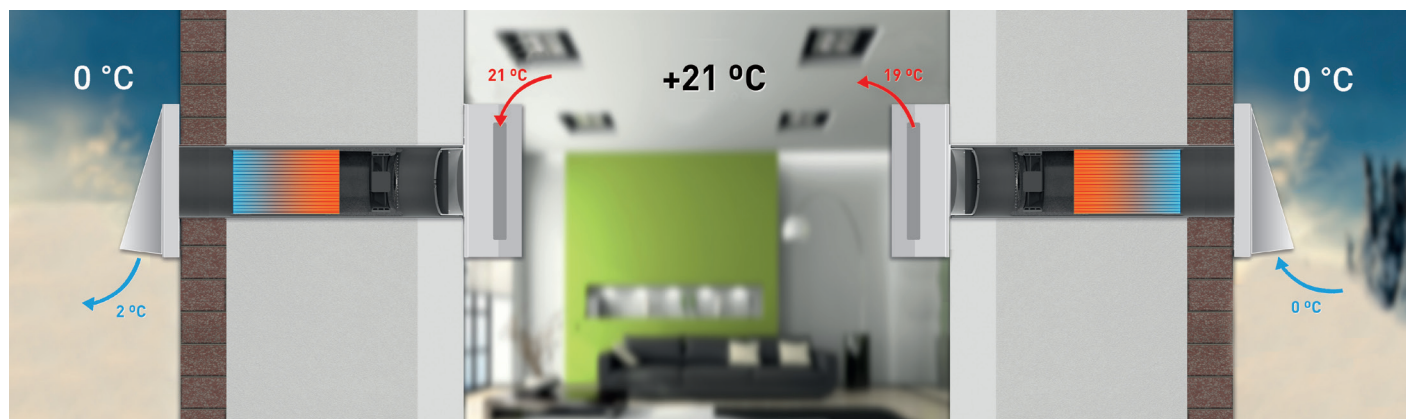

DIMENSIONS (mm)

MODEL 100 / 100 RD

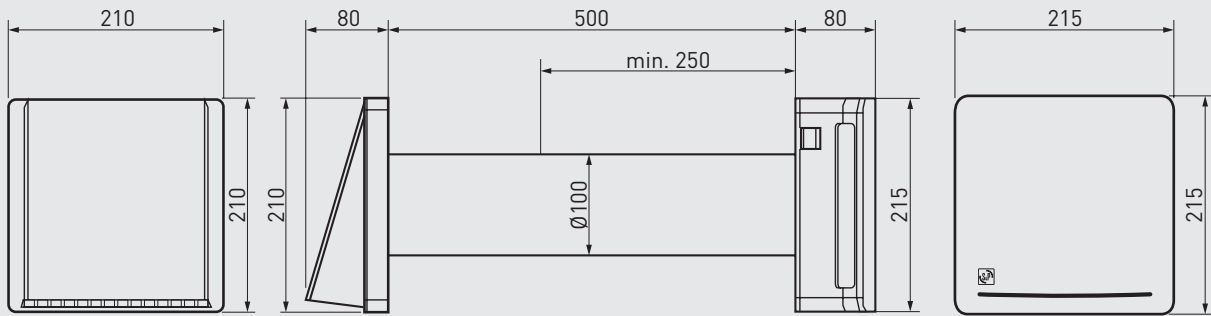

MODEL 150 / 150 RD

